

# CGF (Constant Grip Force) Chuck

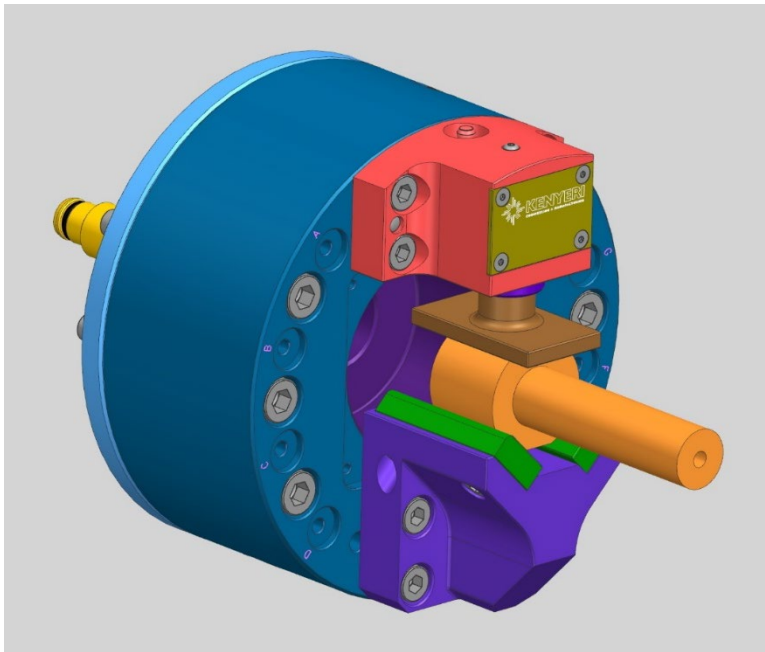

**Developed by Us, Manufactured by Us, Supported by Us!**

**Everything Proudly Done in the USA!**

Our CGF chuck was developed to offer better grip force at speed, so you don't have to grip the part as hard at zero RPM. See the video below that shows the grip force at speed. This will reduce part deformation on delicate, hard to hold parts. There are currently over 30 of these chucks helping a large aerospace company hold compressor blades for jet engines. The chuck is available in various sizes and jaw configurations. If you struggle with part deformation, contact us to discuss your application.

**See it in action**  
[Dynamic Grip Force Video](#)

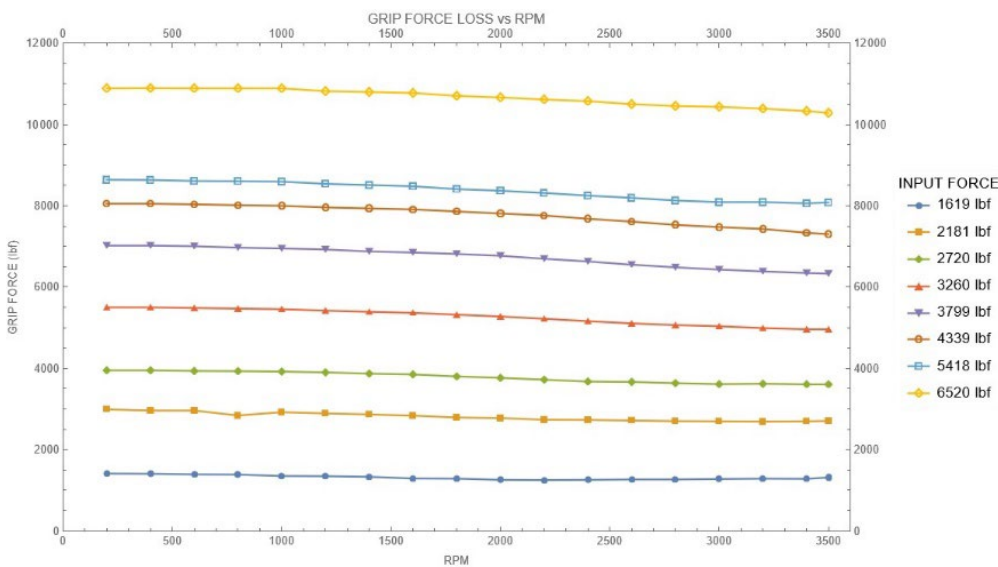

The CGF chuck also offers near perfect repeatability as can be seen in the short video below. Repeatability is better than .005mm and TIR is better than .005mm. This allows the chuck to be used in OP10 and OP20 applications. The chucks we have in the field have proven this to us, so let us prove it to you.

**Outstanding repeatability**  
[Repeatability Video](#)

